

X-LIGHT 2



GUIDA RAPIDA

AVVERTENZE

Collegamento alla rete di alimentazione (per i dispositivi che lo richiedono)

Prima di connettere l'alimentatore/adattatore esterno alla rete, accertatevi che la tensione sia corrispondente a quella indicata tolleranza max $\pm 10\%$.

Collegamenti, accensione e spegnimento

Effettuate i collegamenti sempre ad apparati spenti. Accendete e spegnete l'apparato ad impianto di amplificazione audio spento.

Collegamento di X-Light al computer

Quando viene collegato al computer via USB, X-Light viene automaticamente riconosciuto come doppio dispositivo audio/MIDI, senza bisogno di alcuna installazione software. Solitamente viene indicato come **USB Speaker 1** e **USB Speaker 2**, corrispondenti ai due generatori interni  #1 e  #2, ma il nome può cambiare a seconda dei sistemi operativi o delle applicazioni usate.

Protezione e manutenzione

Evitate esposizioni prolungate dell'apparato all'irradiazione solare diretta, a intense fonti di calore, a forti vibrazioni, ad ambienti particolarmente umidi o polverosi, alla pioggia, poiché possono essere causa di malfunzionamenti, deterioramenti e perfino shock elettrici. Per rimuovere l'eventuale deposito di polvere usate un panno morbido asciutto o un pennello: non usate mai alcool, acetone o solventi vari. Non sono necessarie ulteriori manutenzioni.

In caso di avaria

Tutte le regolazioni dell'apparato sono esterne e facilmente accessibili. In caso di avaria rivolgetevi al **Centro di Assistenza M-LIVE** - e-mail: assistenza@m-live.com

Documentazione

Potete trovare eventuali aggiornamenti o altri supporti sul sito www.m-live.com



9V-DC

Presa per alimentatore (per i dispositivi che lo richiedono)



USB

Porta di comunicazione principale usata tipicamente per il collegamento ad un computer (PC o Mac).

Svolge simultaneamente diverse funzioni:

- **GM#1:** porta MIDI IN - 16 canali
- **GM#2:** porta MIDI IN - 16 canali
- **MP3:** ingresso audio (streaming)

GENERAL GENERAL **mp3**

PHONES

Uscita cuffie (mini-jack stereo)

AUDIO OUT L-R

Uscite audio (RCA stereo)

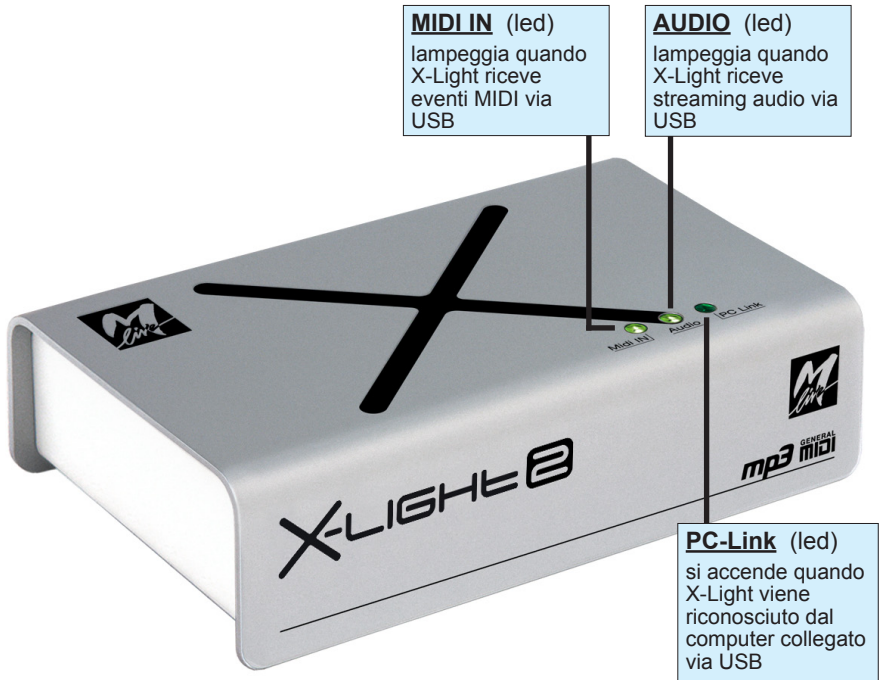

INDICAZIONI DEI LED

I led del pannello frontale indicano le seguenti condizioni:

- **MIDI IN** e **AUDIO**: led **lampeggianti** = dati in arrivo.
- **PC LINK**: led **acceso** = X-Light riconosciuto dal computer.

2 MODULI GENERAL MIDI

X-Light dispone di 2 generatori General MIDI:

- **GENERAL MIDI #1**: 16 canali • 50 note di polifonia max
accessibile tramite Porta USB (USB Speaker 1)
- **GENERAL MIDI #2**: 16 canali • 61 note di polifonia max
accessibile tramite Porta USB (USB Speaker 2)

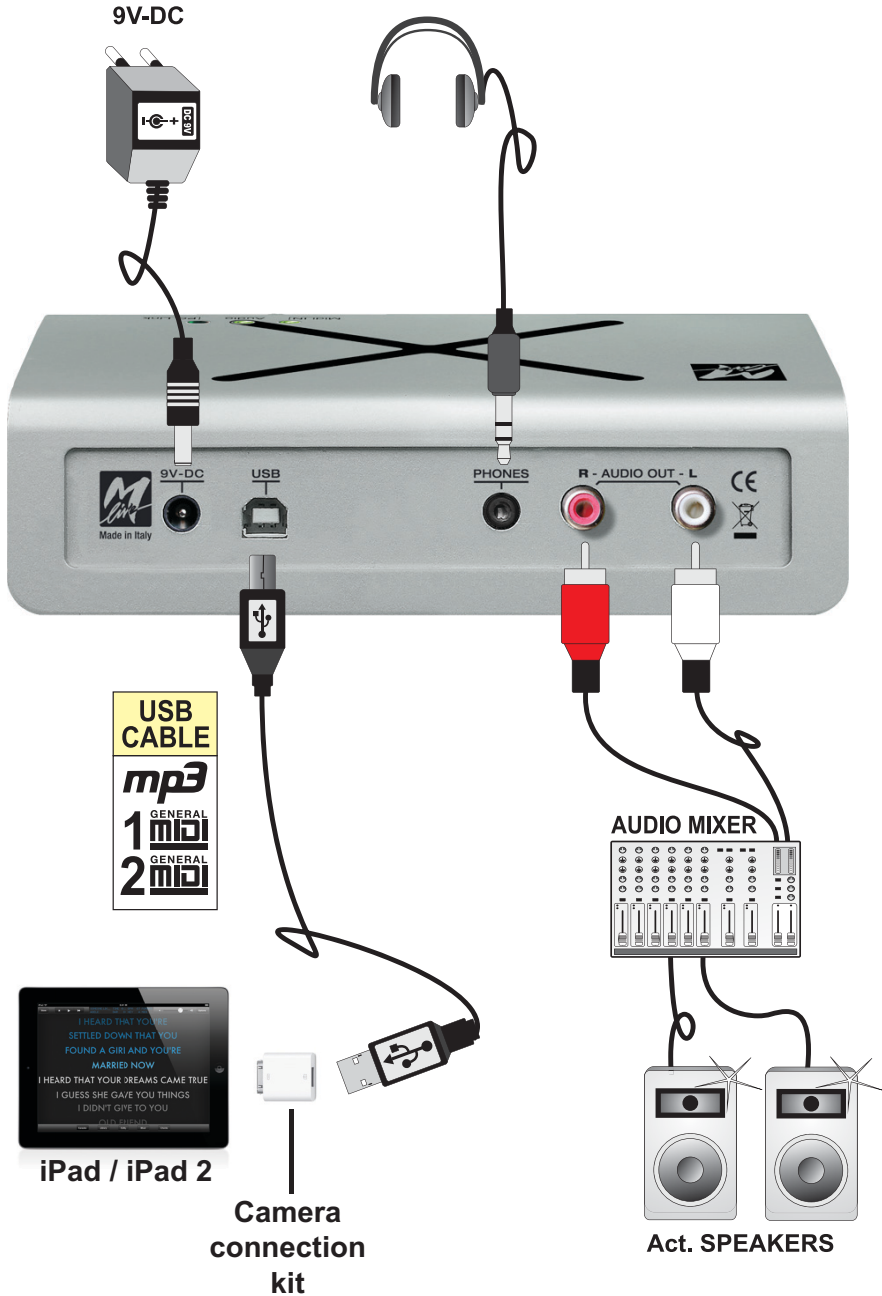

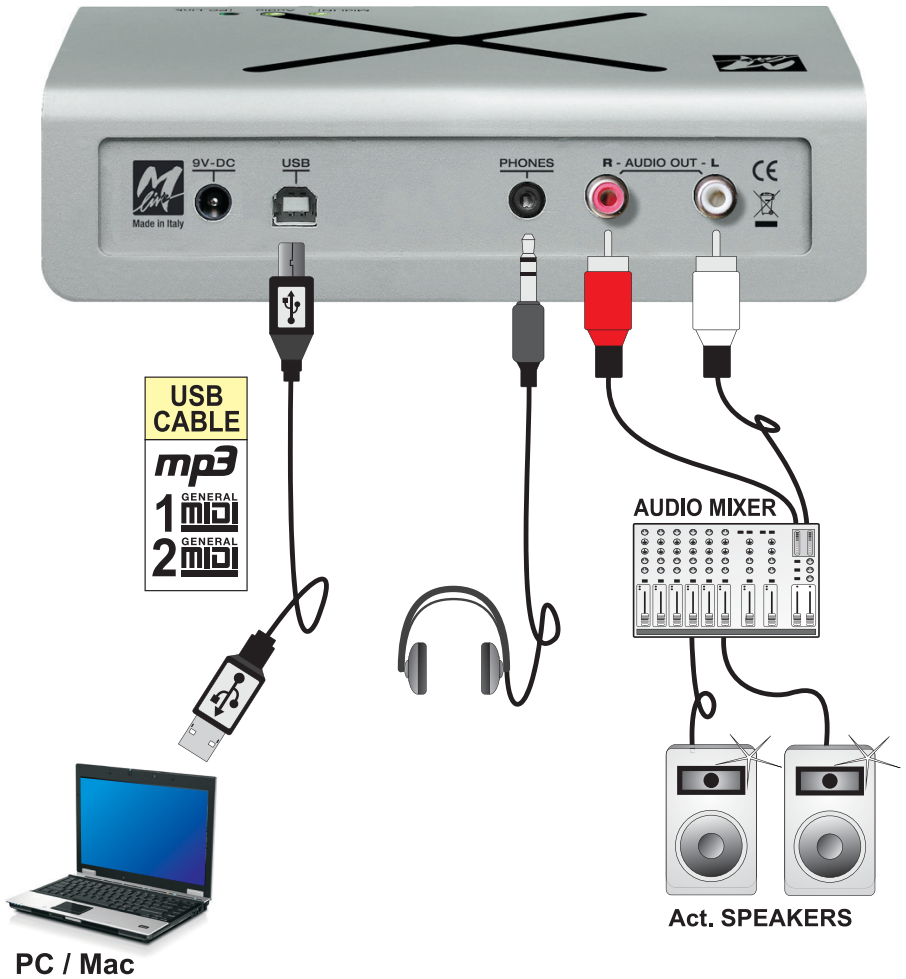

SUONI

PC	CC00	Sound Name	Type
1	0	St.GrandPiano	Ac. Piano
	2	Mono GrandPiano	Ac. Piano
	98	Pianovox 2	Ac. Piano
	99	Piano & Strings	Ac. Piano
2	0	Stage Ac.Piano	Ac. Piano
	98	Pianovox 1	Ac. Piano
	99	Pianopad	Ac. Piano
3	0	El. GrandPiano	El. Piano
	98	Chip 80 Atmos	El. Piano
	99	Bass & Piano	El. Piano
4	0	Honky-Tonk	Ac. Piano
	99	Latin Piano	Ac. Piano
5	0	Stage El.Piano	El. Piano
	1	El. Piano 2	El. Piano
	8	Detuned EP 1	El. Piano
	9	Soft El.Piano	El. Piano
	16	FM+SA EP	El. Piano
	24	60's El.Piano	El. Piano
	32	Hard Rodex	El. Piano
	40	Rodex	El. Piano
	99	Electric Mood	El. Piano
6	0	El. FM Piano	El. Piano
	8	Detuned EP 3	El. Piano
	9	Detuned EP 2	El. Piano
	16	FM Soft EP	El. Piano
	24	Hard FM EP	El. Piano
	32	El. Piano 3	El. Piano
	99	FM & Pad	El. Piano
7	0	Harpsichord	El. Piano
	8	Coupled Harpsi	El. Piano
	99	Harpsistrings	El. Piano
8	0	Clavinet	El. Piano
9	0	Celesta	Chromatic Perc.
10	0	Glockenspiel	Chromatic Perc.
11	0	Music Box	Chromatic Perc.
12	0	Vibes	Chromatic Perc.
	1	Vibraphone	Chromatic Perc.
13	0	Marimba	Chromatic Perc.
	8	Balafon	Chromatic Perc.
14	0	Xylophone	Chromatic Perc.
15	0	Tubular Bells	Chromatic Perc.
	8	Church Bell	Chromatic Perc.
	9	Carillon	Chromatic Perc.
16	0	Santur	Chromatic Perc.
17	0	Drawbar Organ	Organ
	8	Detuned Organ 1	Organ
	9	Ham 109 Organ	Organ
	16	60's Organ	Organ
	24	PedalBass Organ	Organ
	32	Even Bar	Organ

PC	CC00	Sound Name	Type
18	0	Perc. Organ 1	Organ
	1	Perc. Organ 2	Organ
	8	Detuned Organ 2	Organ
	9	Jazz Organ	Organ
	16	Detuned Organ 3	Organ
19	24	Jazz Vib Organ	Organ
	0	Rock Organ 1	Organ
	1	Rock Organ 2	Organ
	8	Rotary Switch	Organ
	16	Rotary Percuss.	Organ
20	24	Rotary Fast	Organ
	99	Organizer	Organ
	0	Church Organ 1	Organ
	8	Church Organ 2	Organ
21	0	Reed Organ	Organ
22	0	Fisa Musette	Accordion
	1	French Musette	Accordion
	8	Ital Accordion	Accordion
	99	Folk Lead	Accordion
23	0	Harmonica	Accordion
24	0	Bandoneon	Accordion
	0	Nylon Live Gtr	Ac. Guitar
	1	Nylon Guitar	Ac. Guitar
	8	Ukulele	Ac. Guitar
	9	VeloHarmnix	Ac. Guitar
	16	Nylon Gt.o	Ac. Guitar
	0	Steel Strum.Gtr	Ac. Guitar
25	1	Steel Guitar	Ac. Guitar
	5	SteelstringsGtr	Ac. Guitar
	8	12-Strings Gtr1	Ac. Guitar
	9	12-Strings Gtr2	Ac. Guitar
	16	Mandolin	Ac. Guitar
	24	Steel Guitar 2	Ac. Guitar
	32	Steel Guitar 3	Ac. Guitar
26	40	Nylon + Steel	Ac. Guitar
	0	Jazz Guitar 1	El. Guitar
	1	Jazz Guitar 2	El. Guitar
	8	Hawaiian Guitar	El. Guitar
	0	Clean Live Gtr	El. Guitar
27	1	Clean Guitar	El. Guitar
	8	Chorus Guitar 2	El. Guitar
	16	Clean Guitar 2	El. Guitar
	99	Clean Pad	El. Guitar
	0	Muted Guitar 1	El. Guitar
28	1	Muted Guitar 2	El. Guitar
	8	Funk Guitar	El. Guitar
	16	Chorus Funk	El. Guitar
	24	Funky Okytar	El. Guitar
	0	OverdriveLP Gtr	El. Guitar
29	1	Overdrive Gtr 1	El. Guitar
	8	Overdrive Gtr 2	El. Guitar
	8	Funk Guitar	El. Guitar
30	16	Chorus Funk	El. Guitar
	24	Funky Okytar	El. Guitar
30	0	OverdriveLP Gtr	El. Guitar
	1	Overdrive Gtr 1	El. Guitar
8	Overdrive Gtr 2	El. Guitar	



PC	CC00	Sound Name	Type
31	0	Distorted Gtr 1	El. Guitar
	1	Distorted Gtr 2	El. Guitar
	8	Feedback Guitar 1	El. Guitar
32	0	Dist.Harmonix 1	El. Guitar
	1	Dist.Harmonix 2	El. Guitar
	8	Feedback Guitar 2	El. Guitar
33	0	Acoustic Bass	Bass
	0	Fingered Bass 1	Bass
	1	Finger Okybass	Bass
34	8	Fingered Bass 2	Bass
	16	Dynamic Bass	Bass
	0	Picked & Hybrid	Bass
35	1	Picked Okybass	Bass
	0	Fretless Bass 1	Bass
36	1	Fretless Bass 2	Bass
	0	Slap Bass 1	Bass
37	16	Slap Bass 3	Bass
	0	Slap Bass 2	Bass
39	0	Synth Bass 1	Synth Bass
	1	Synth Okybass	Synth Bass
	5	Reso SH Bass	Synth Bass
	6	Synth Bass 5	Synth Bass
	8	Synth Bass 3	Synth Bass
	9	TB 303 Bass	Synth Bass
	16	Tekno Bass 1	Synth Bass
	24	Tekno Bass 2	Synth Bass
	32	Sq 303 Flat	Synth Bass
	40	Sq 303 Overdr.	Synth Bass
40	0	Rubber Bass	Synth Bass
	1	Synbass 201	Synth Bass
	2	Modular Bass	Synth Bass
	3	Seq Bass	Synth Bass
	4	Analogic Bass	Synth Bass
	5	Subsonic Bass	Synth Bass
	6	Synth Bass 6	Synth Bass
	8	Synth Bass 4	Synth Bass
	9	Smooth Bass	Synth Bass
	16	Synth Bass 2	Synth Bass
	24	80's Bass	Synth Bass
	32	SH101 Bass 1	Synth Bass
40	SH101 Bass 2	Synth Bass	
41	0	Violin Solo	Strings
	1	Violin	Strings
42	0	Viola Solo	Strings
	1	Viola	Strings
43	0	Cello Solo	Strings
	1	Cello	Strings
44	0	Double Bass	Strings
	1	Contrabass	Strings
45	0	Tremolo Strings	Strings Ensemble
46	0	Pizzicato Strings	Strings Ensemble

PC	CC00	Sound Name	Type
47	0	Orchestral Harp	Strings Ensemble
	1	Mellow Harp	Strings
48	0	Timpani 1	Percussion
	1	Timpani 2	Percussion
49	0	Stereo Strings	Strings Ensemble
	2	Mono Strings	Strings Ensemble
	8	Ensemble Orch.	Strings Ensemble
	99	Jazzstrings	Strings Ensemble
50	0	Slow St.Strings	Strings Ensemble
	2	Slow MonoStrings	Strings Ensemble
51	0	Synth Strings 1	Strings Ensemble
	8	Synth Strings 3	Strings Ensemble
52	0	Synth Strings 2	Strings Ensemble
	1	Synth Section	Strings Ensemble
53	0	Choir St. Aahs	Vocals
	1	Choir Aahs	Vocals
	2	Choir Mono Aahs	Vocals
	8	Real Choirs Vib	Vocals
54	0	Choir St. Oohs	Vocals
	1	Choir Oohs	Vocals
55	0	Synvox Stereo	Vocals
	1	Synvox	Vocals
56	0	Orchestra Hit	SFX
	8	Impact Hit	SFX
	9	Philly Hit	SFX
57	0	Trumpet 1	Brass
	1	Classic Trumpet	Brass
	8	Flugel Horn	Brass
	9	Trumpet 2	Brass
	16	Mariachi	Brass
	24	Bright Trumpet	Brass
	32	Sharp Trumpets	Brass
	40	Trumpet 3	Brass
58	0	Trombone Solo	Brass
	1	Dark Bone	Brass
59	0	Tuba	Brass
	0	Muted Trumpet 1	Brass
60	8	Muted Trumpet 2	Brass
	0	Dyn.FrenchHorns	Brass
61	1	French Horns	Brass
	0	Brass Section 1	Brass
62	8	Brass Section 2	Brass
	16	Brass Fall	Brass
63	0	Synth Brass 1	Brass
	8	Synth Brass 3	Brass
64	0	Synth Brass 2	Brass
	8	Synth Brass 4	Brass
65	0	Soprano Sax 1	Sax
	8	Soprano Sax 2	Sax



SUONI

PC	CC00	Sound Name	Type
66	0	Alto Sax 1	Sax
	1	Alto Okysax	Sax
	2	Liscio Sax	Sax
	8	Hyper Alto Sax	Sax
	9	Alto Sax 2	Sax
67	0	Tenor Sax	Sax
	8	Breathy Tenor	Sax
68	0	Baritone Sax 1	Sax
	8	Baritone Sax 2	Sax
69	0	Oboe	Woodwinds
70	0	English Horn 1	Woodwinds
	8	English Horn 2	Woodwinds
71	0	Bassoon	Woodwinds
	8	Bassoon 2	Woodwinds
72	0	Clarinet	Woodwinds
	8	Bass Clarinet	Woodwinds
73	0	Piccolo	Pipes
74	0	Flute Vibrato	Pipes
	1	Flute	Pipes
75	0	Recorder	Pipes
76	0	Panflute Vibrato	Pipes
	1	Panflute	Pipes
	99	Pan Atmos	Pipes
77	0	Bottle Blown	Pipes
78	0	Shakuhaci	Pipes
79	0	Whistle	Pipes
80	0	Ocarina	Pipes
81	0	Square Synwave1	Synth Lead
	8	Sine Wave	Synth Lead
	16	Square Synwave2	Synth Lead
82	0	Dance Saw Wave	Synth Lead
	1	Saw Synwave 1	Synth Lead
	8	Saw Synwave 2	Synth Lead
	16	Killer Synth	Synth Lead
	99	House combo	Synth Lead
83	0	Syn Calliope	Synth Lead
84	0	Chiffer Lead	Synth Lead
85	0	Dist.Charang	El. Guitar
	1	Charang GM	Synth Lead
86	0	Solo Vox	Synth Lead
87	0	5th Saw Synth	Synth Pad
88	0	Bass & Lead	Synth Pad
89	0	Fantasia Pad	Synth Pad
	99	SaXoPad	Synth Pad
90	0	Warm Stereo Pad	Synth Pad
	1	Air Stereo Pad	Synth Pad
	2	Warmono Pad	Synth Pad
	3	Okywarm Pad	Synth Pad
	8	Rotary Strings	Synth Pad
	99	Solo & Pad	Synth Pad
91	0	Poly Synth Pad	Synth Pad
92	0	Space Voice Pad	Synth Pad
93	0	Bowed Glass Pad	Synth Pad

PC	CC00	Sound Name	Type
94	0	Metal Pad	Synth Pad
95	0	Halo Pad	Synth Pad
96	0	Sweeping Pad	Synth Pad
	1	Okysweep Pad	Synth Pad
97	0	Ice Rain	Synth Pad
98	0	Soundtrack	Synth Pad
99	0	Crystal Pad	Synth Pad
100	0	Atmosphere	Synth Pad
101	0	Brightness	Synth Pad
102	0	Goblin	Synth Pad
	0	Echo Drops	Synth Pad
103	8	Echo Pan	Synth Pad
	104	0	Star Theme
105	0	Sitar	Ethnic
106	0	Banjo	Ethnic
107	0	Shamisen	Ethnic
	0	Koto	Ethnic
108	8	Taisho Koto	Ethnic
	109	0	Kalimba
110	0	Bagpipes	Ethnic
111	0	Fiddle	Ethnic
112	0	Shanai	Ethnic
113	0	Tinkle Bell	Percussion
114	0	Agogo	Percussion
115	0	Steel Drums	Chromatic Perc.
	0	Woodblock	Percussion
116	8	Castanets	Percussion
	117	0	Taiko
8		Concert B-drum	Percussion
118	0	Melodic Toms 1	Percussion
	8	Melodic Toms 2	Percussion
119	0	Synth Drums	Percussion
	8	TR-808 Toms	Percussion
	9	El.Percussions	Percussion
120	0	Reverse Cymbal1	SFX
	1	Reverse Cymbal2	SFX
121	0	Gr. Fret Noise	SFX
	1	Gr. Cut Noise	SFX
	2	String Slap	SFX
	5	Bass Slide	SFX
	6	Pick Scrape	SFX
122	0	Breath Noise	SFX
	1	Fl. Key Ckick	SFX
123	0	Seashore	SFX
	1	Rain	SFX
	2	Thunder	SFX
	3	Wind	SFX
	4	Stream	SFX
	5	Bubbles	SFX
124	0	Bird 1	SFX
	1	Dog	SFX
	2	Horse Gallop	SFX
	3	Bird 2	SFX



PC	CC00	Sound Name	Type
125	0	Telephone Ring1	SFX
	1	Telephone Ring2	SFX
	2	Door Creaking	SFX
	3	Door Closing	SFX
	4	Scratch	SFX
	5	Wind Chime	SFX
126	0	Helicopter	SFX
	1	Car Engine Start	SFX
	2	Car Breaking	SFX
	3	Car Pass	SFX
	4	Car Crash	SFX
	5	Police Siren	SFX
	6	Train	SFX
	7	Jet Takeoff	SFX
	8	Starship	SFX
9	Burst Noise	SFX	
127	0	Applause	SFX
	1	Laughing	SFX
	2	Screaming	SFX
	3	Punch	SFX
	4	Heart Beat	SFX
	5	Footstep	SFX
128	0	Gun Shot	SFX
	1	Machine Gun	SFX
	2	Laser Gun	SFX
	3	Explosion	SFX

DRUMKIT

PC	Drumkit Name
1	Standard Set 1
2	Standard Set 2
3	R&B Set
4	Hip-Hop Set
5	Okydrum Set
6	Standard Set 3
7	Standard Set 4
8	Standard Set 5
9	Room Set
17	Power Set
25	Electronic Set
26	Tr-808 Set
27	Dance Set 1
28	Techno Set
29	Dance Set 2
30	Electronic Set 2
31	Electronic Set 3
33	Jazz Set 1
34	Jazz Set 2
41	Brush Set
49	Orchestra Set
50	Ethnic Set 1

PC	Drumkit Name
51	Ethnic Set 2
54	Bd & Sd Set
57	Sfx Set
128	Cm-64/32 Set





INFORMAZIONI UTILI AGLI UTENTI

Ai sensi dell'art. 13 del Decreto Legislativo 25 luglio 2005, n. 151 "Attuazione delle Direttive 2002/95/CE, 2002/96/CE e 2003/108/CE, relative alla riduzione dell'uso di sostanze pericolose nelle apparecchiature elettriche ed elettroniche, nonché allo smaltimento dei rifiuti" questo prodotto è conforme.

ATTENZIONE!

Il simbolo del cassonetto barrato riportato sull'apparecchiatura o sulla sua confezione indica che il prodotto alla fine della propria vita utile deve essere raccolto separatamente dagli altri rifiuti.



INFORMAZIONI SULLO SMALTIMENTO PER GLI UTENTI PRIVATI

L'utente dovrà, pertanto, conferire l'Apparecchiatura giunta a fine vita agli idonei centri di raccolta differenziata dei Rifiuti Elettronici ed Elettrotecnici, oppure riconsegnarla al rivenditore al momento dell'acquisto di una nuova apparecchiatura di tipo equivalente, in ragione di uno a uno.

INFORMAZIONI SULLO SMALTIMENTO PER GLI UTENTI COMMERCIALI

L'adeguata raccolta differenziata per l'avvio successivo dell'apparecchiatura dismessa al riciclaggio, al trattamento ed allo smaltimento ambientalmente compatibile contribuisce ad evitare possibili effetti negativi sull'ambiente e sulla salute e favorisce il reimpiego e/o riciclo dei materiali di cui è composta l'apparecchiatura. Lo smaltimento abusivo del prodotto da parte dell'utente comporta l'applicazione delle sanzioni amministrative previste dalla normativa vigente.



